

# Hot work

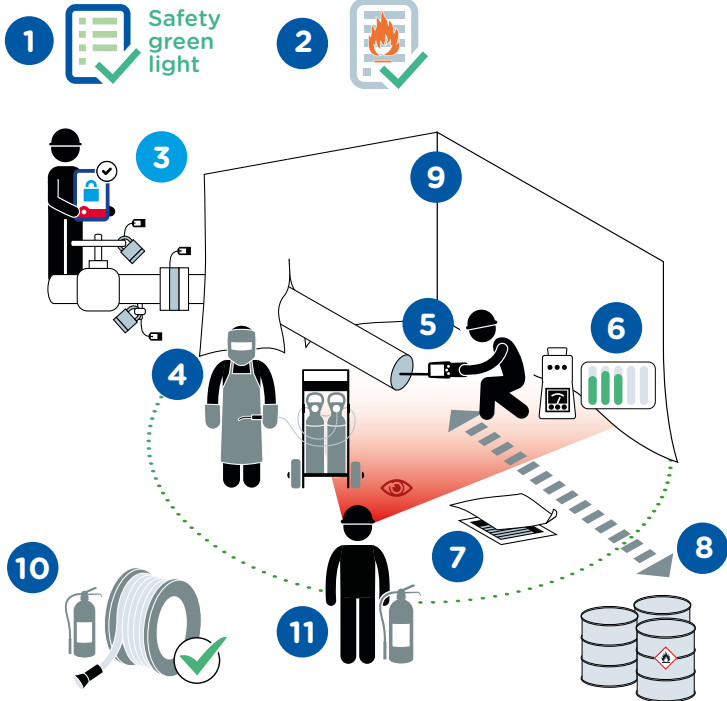

**2 fatalities** related to hot work occurred within the Company in the last 10 years.



TotalEnergies



# Hot work

Location \_\_\_\_\_ Date \_\_\_\_\_

Company observed \_\_\_\_\_ Permit No. \_\_\_\_\_



September 2021

YES NO N/A

## POINTS TO BE CHECKED

- 1** Has the "Safety green light" been carried out?
- 2** Is the hot work permit validated?
- 3** Use the checklist "Work on de-energized systems" for each energy and answer: do all applicable points comply?
- 4** Do personnel performing the activity wear specific PPE for the task?
- 5** In an area with a potentially explosive atmosphere, has a gas test been completed prior to hot work?
- 6** In an area with a potentially explosive atmosphere, is continuous monitoring of the atmosphere or is gas testing with a defined frequency carried out, and results monitored?
- 7** Are drains, openings and vents shielded?
- 8** Have all combustible materials been removed, covered or kept wet in the hot work area?
- 9** When required by the work permit, are spark protection covers in place?
- 10** Has firefighting equipment been inspected, is it available at hot work site and ready for use?
- 11** When required by the work permit, is the fire watch in place?

Compliance rate (Nb YES/applicable points): \_\_\_\_\_ / \_\_\_\_\_ ( \_\_\_\_\_ %)

Comments \_\_\_\_\_

Name \_\_\_\_\_ Company \_\_\_\_\_

Signature \_\_\_\_\_